

# OPERATING MANUAL

## Stripper COSMO III

Order-No.

111 830 000



This manual covers to the best of our knowledge, the operation and maintenance of the **COSMO III Stripper**. Before operation of the equipment the manual should be read and understood by the operator. The safety regulations must be followed at all times. Service of electrical components should be carried out by authorised personnel. Failure to follow these instructions could result in damage to the machine and/or serious personal injury or death.

**WARNING** Failure to follow these instructions may result in serious personal injury or death. The manufacturer disclaims all responsibility for damage to persons or objects arising as a consequence of incorrect handling of the machine and failure to inspect the machine for damage or other faults that may influence the operation prior to starting work.

**Janser**

PROFESSIONAL  
FLOORING  
TECHNOLOGY

Janser GmbH  
Böblinger Straße 91  
D-71139 Ehningen

Telefon 07034 / 127-0 -  
Telefax 07034 / 8838

info@janser.com  
www.janser.com

## INDEX

Chapter		Page No
1	Product Information	3
2	Starting Work	4
3	Electrical Instructions	4
4	Safety	4
5	Maintenance	5
6	Spare Parts	6-7
7	Wiring Diagram	
	Electrical Listing	8
	Declaration of Conformity	9

# 1 PRODUCT INFORMATION

## TECHNICAL SPECIFICATION

<b>Power output</b>	2.0 h.p
<b>Voltage</b>	230v
<b>Cycles</b>	50
<b>Machine dimensions (mm)</b>	
<b>Length</b>	830
<b>Width</b>	340
<b>Height</b>	840
<b>Weight (kg)</b>	62
<b>Working width mm</b>	230
<b>Engine/Motor rpm</b>	1400

## ELECTRICAL REQUIREMENTS

Volts	Plug size	Cable size (mm)	Norm Cable Length	Transformer	Generator
230	16A 3 pin	2.5mm 3 core	30 metres		5 Kva

## RECORD OF NOISE AND VIBRATION ASSESSMENT

Type: Tile Lifter  
 Model No. COSMO III  
 Operation : Free running  
 Running Conditions: 1420 rpm

## HAND-ARM VIBRATION

Frequency Weighted Energy Equivalent Accelerations ( $a_{h,w}$ )				
Measurement Position	Acceleration ( $m/s^2$ )			
	X axis	Y axis	Z axis	Vector Sum
Handle	8.09	7.37	12.70	16.75

## NOISE LEVELS

Sound Power Level ( $L_{WA}$ )								
$L_{WA}$ at Octave Band Centre Frequency (Hz)								Sound Power Level $L_{WA}$
63	125	250	500	1000	2000	4000	8000	
46.2	57.0	63.8	69.3	69.3	76.6	73.4	64.5	79.5

Operator's Ear									
$L_{Aeq,T}$ at Octave Band Centre Frequency (Hz)								Overall Level ( $L_{Aeq,T}$ )	$L_{Peak}$ dB(C)
63	125	250	500	1000	2000	4000	8000		
29.6	36.9	44.6	51.3	61	63.1	59.6	49.8	68.3	85.9

## 2 STARTING WORK

- 1) Check the condition of the blade assembly
- 2) Check all bolts and nuts for tightness
- 3) Check all leads for damage where applicable
- 4) Before starting the machine ensure that the blade is clear of any obstructions
- 5) Adjust the handlebar to a comfortable height and position.
- 6) Adjust the blade angle to a suitable setting – See blade angle (page 5)
- 7) Start the motor by turning the switch to the on position.

NOTE: If removing sheet vinyl or carpet cut the material into strips with a knife at approximately the width of the COSMO III blade.

## 3 ELECTRICAL INSTRUCTIONS

Extension cables must be no less than 2.5 mm (normal length 30 metres)

All cables should be fully uncoiled and never left wrapped around cable reels or tied in loops.

An RCD unit must be used with the COSMO III 240v.

## 4 SAFETY

- 1) Only trained operatives should be allowed to work the COSMO III
- 2) Appropriate PPE must be worn.
- 3) Keep hands and feet away from the moving blade at all times
- 4) Keep the electric lead away from the moving blade
- 5) Never leave the COSMO III unattended whilst in use. Always stop the motor before leaving the machine.
- 6) Always ensure that all power leads are disconnected before attempting to service the machine. Never tip the machine backwards until the blade has stopped moving.
- 7) Do not use in wet conditions
- 8) Always use the correct voltage for the machine and RCD protection
- 9) Be careful when working around pipes or ducts protruding from the floor as the moving blade may cause damage to them
- 10) Extreme care should be taken when changing the blades. The blades are sharp and suitable protection should be used when handling them.
- 11) Equipment must be used in line with guidelines laid down by the Health & Safety Executive.

Noise and vibration will occur at various levels dependent on the attachments and work being completed. THE MANUFACTURER have assessments conducted under test conditions detailed in the operating manual, see page 3. However, it is recommended that additional tests are taken on site to provide the operator with accurate information on using the equipment within the guidelines laid down by the Health and Safety Executive.

## 5 MAINTENANCE

### AFTER USE:

- Clean the machine to remove all the build up of dust and surface residue. If using a hose pipe or pressure washer take care that water is not directed onto electrical components and switches. (Note: Motors and switches are not waterproof)
- All components should be checked daily for tightness.

### BLADE CHANGE

- 1) Isolate from the power supply
- 2) Loosen the blade clamp bolts and slide out the blade. Insert the new blade and tighten the clamp bolts

**Note:** The operator should be aware that the blades are sharp and use suitable protection when handling them.

**Spare Blade 230 x 75 x 1,6 mm**

Order-No 111 800 107



### BLADE ANGLE

The angle of the blade can be altered to suit different applications

- 1) Loosen the thumb screws on either side of the chassis
- 2) Adjust the angle to a suitable setting
- 3) Tighten the thumb screws

### BASIC MAINTENANCE/CHECKLIST:

**This checklist should be undertaken every 8hrs to 10hrs - taking into account the vibrating action of machine**

- DISCONNECT FROM THE POWER SUPPLY
- Check the condition of the blade
- Check all bolts and nuts for tightness
- Grease all moving parts on the sliding blade mechanism
- Check all the electric cables and plugs

## 6 SPARE PARTS

Parts List			
ITEM	QTY	SPE PART NUMBER	DESCRIPTION
1	1	C305A	Drive Motor
2	1	C312	Drive Arm
3	1	C307	Bearing
4	1	C314	Deflector
5	1	C306	Eccentric Bush
6	1	C327	Brass Bush
7	1	C315	Motion Arm
8	2	C331	Bolt Spacer
9	1	C341	Spring
10	1	C309	Switch
11	1	C301	Blade

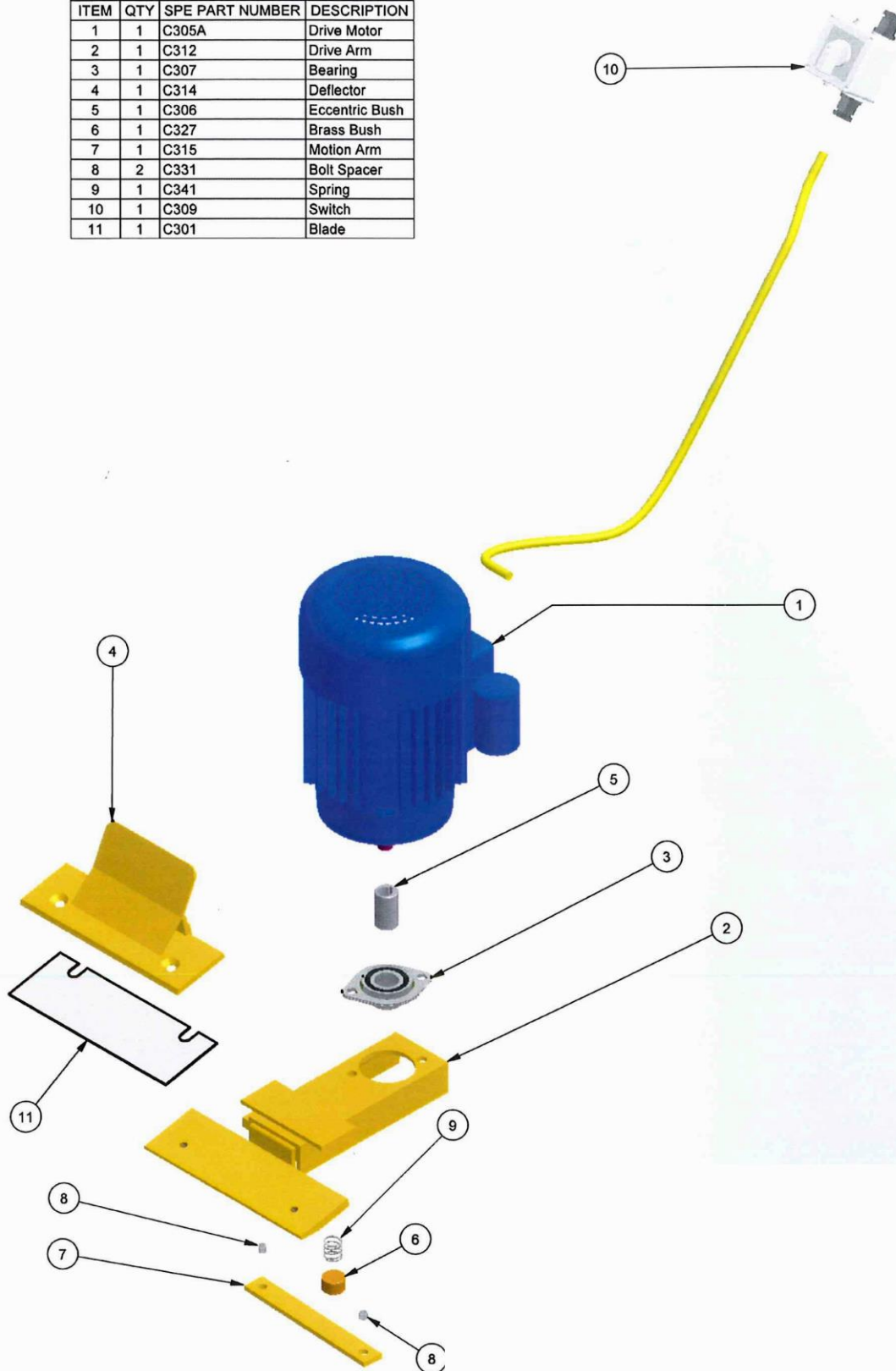

## 6 SPARE PARTS

Parts List			
ITEM	QTY	SPE PART NUMBER	DESCRIPTION
1	1	C311	Chassis
2	1	C323	Axle Fork
3	4	C321	Threaded Knob (M10)
4	1	C319	Handle
5	1	C328	Wear Strip
6	1	C313	Bearing Arm
7	1	C323A	Axle
8	2	C318	Side Arm
9	2	C324	Wheel Bearing Sleeve
10	2	6013	Wheel
11	2	9104	Handlebar Grip
12	4	C323B	Axle Spacer

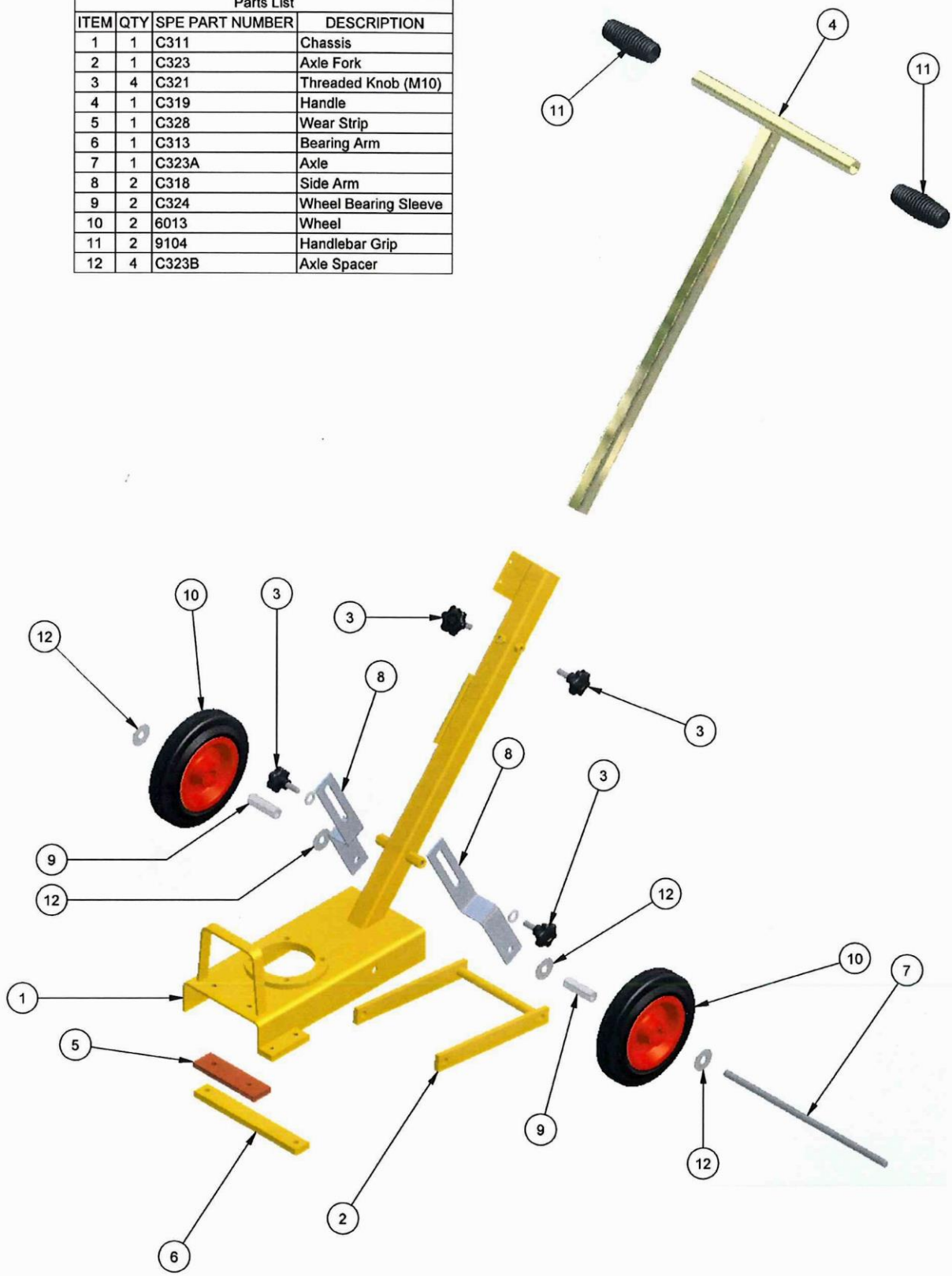

## 7 WIRING DIAGRAMM

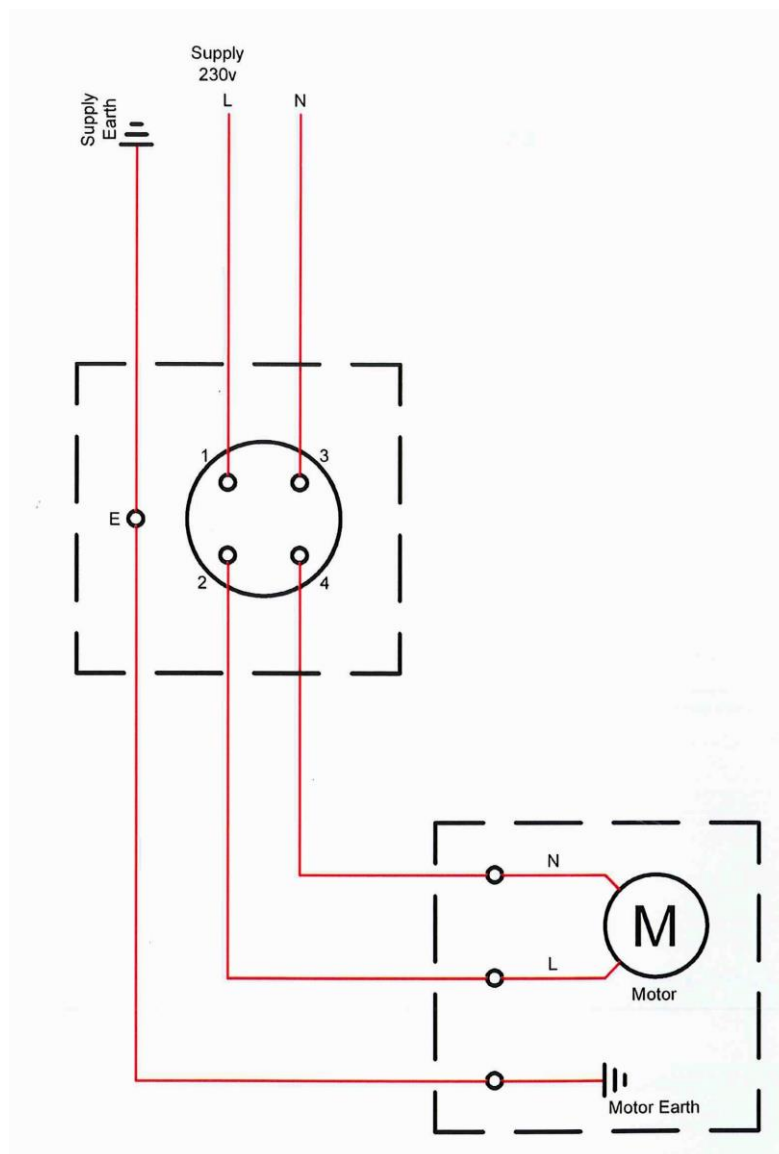

Part no	Description	Qty
25MF@400V	Run Capacitor 230v	1
125MF@240V	Start Capacitor 230v	1
SP210-306	230v 16A 3 pin Trailing Plug	1
7536	1.5mm Cable - Black	5 mtrs



## DECLARATION OF CONFORMITY

WE **Janser GmbH**  
Böblinger Straße 91  
71139 Ehningen  
GERMANY

**DECLARE** that under our sole responsibility for the supply/manufacture of the product

(Description/name)	Stripper
(Model/type)	COSMO III
Referene	111 830 000

to which this declaration relates is in conformity with the following standards and other normative documents following the provisions of Directive 2006/42/EC.